

A photograph of a modern building with a glass facade and a large, curved, white architectural element. The building is illuminated by warm, golden light, suggesting sunset or sunrise. The sky is a deep blue with some clouds. The word "INSPIRE." is written in large, white, sans-serif capital letters across the top of the image.

INSPIRE.



DESIGN PROFESSIONAL RESOURCE GUIDE

# Streamlined, Simplified Project Designs and Specifications

*What does that mean for you and your next project?*

It means you can achieve structures that blend high performance with cutting-edge aesthetics — all from one manufacturer — with support throughout the construction process.

It's all possible through Tremco Construction Products Group (CPG). Tremco CPG combines the strength and sustainability of Nudura™ insulated concrete forms, the proven performance and durability of Tremco sealants, waterproofing and barriers, and the maximum efficiency of Dryvit™ Outsulation® continuous insulation systems and their limitless combinations of color, texture and finish options.

pg.	CONTENTS	
3	<b>ENVISION</b>	Explore a full collection of color, texture and finish options.
4	<b>DESIGN</b>	Access technical documents and resources.
5	<b>TEST</b>	Be confident your structure will perform as intended.
6	<b>SPECIFY</b>	Create project documents easily with downloadable specs.
7	<b>SIMPLIFY</b>	Incorporate a turn-key whole wall system in your next project.
8	<b>CONSERVE</b>	Protect the environment and meet any sustainability standard.
9	<b>PROTECT</b>	Mitigate risk with a single warranty.
10	<b>SAMPLE</b>	Browse and order product samples and literature.
11	<b>LEARN</b>	Expand your knowledge and fulfill your CE requirements.
12	<b>OBSERVE</b>	See the Tremco CPG difference for yourself with video spotlights.

*(on the cover)*

**One River North | Denver, Colorado**

**MAD Architects & Davis Partnership Architects**

Dryvit® Outsulite® panelized EIFS

Dryvit® textured finishes

Tremco® sealants

Willseal® pre-compressed foam expansion joints





# ENVISION.

Artspace | Ridgway, Colorado  
Dryvit Panelization and Finishes

## MAKE YOUR NEXT PROJECT STAND OUT

See for yourself Dryvit's full collection of color, texture and finish options — plus our Building Visualizer Tool — through the buttons and links below.

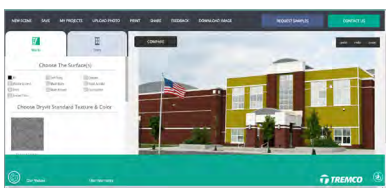

Try out the  
Building Visualizer Tool



View Standard Color  
Inspiration Book



View Specialty Finishes  
Inspiration Book

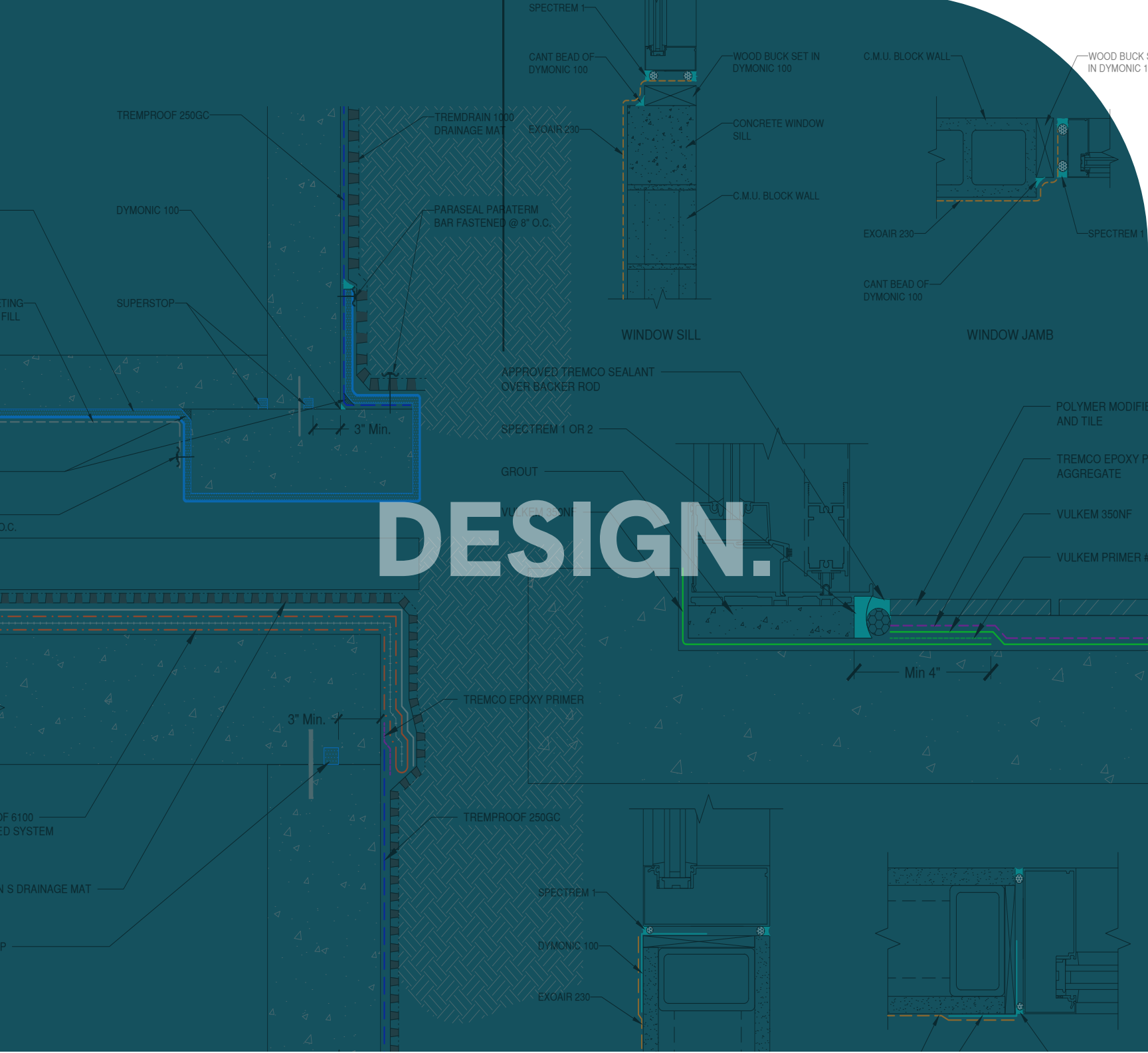

# DESIGN.

## ACCESS TECHNICAL DOCUMENTS & RESOURCES

Get direct access to technical documents, including detail drawings, specifications, data sheets, and more through the buttons below.



Technical Document Library

Submittal Builder



Technical Document Library

Design Library



Technical Document Library

E-Submittals

# TEST.

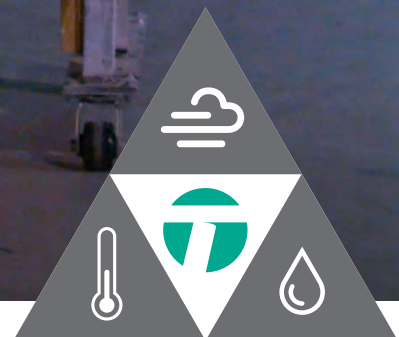
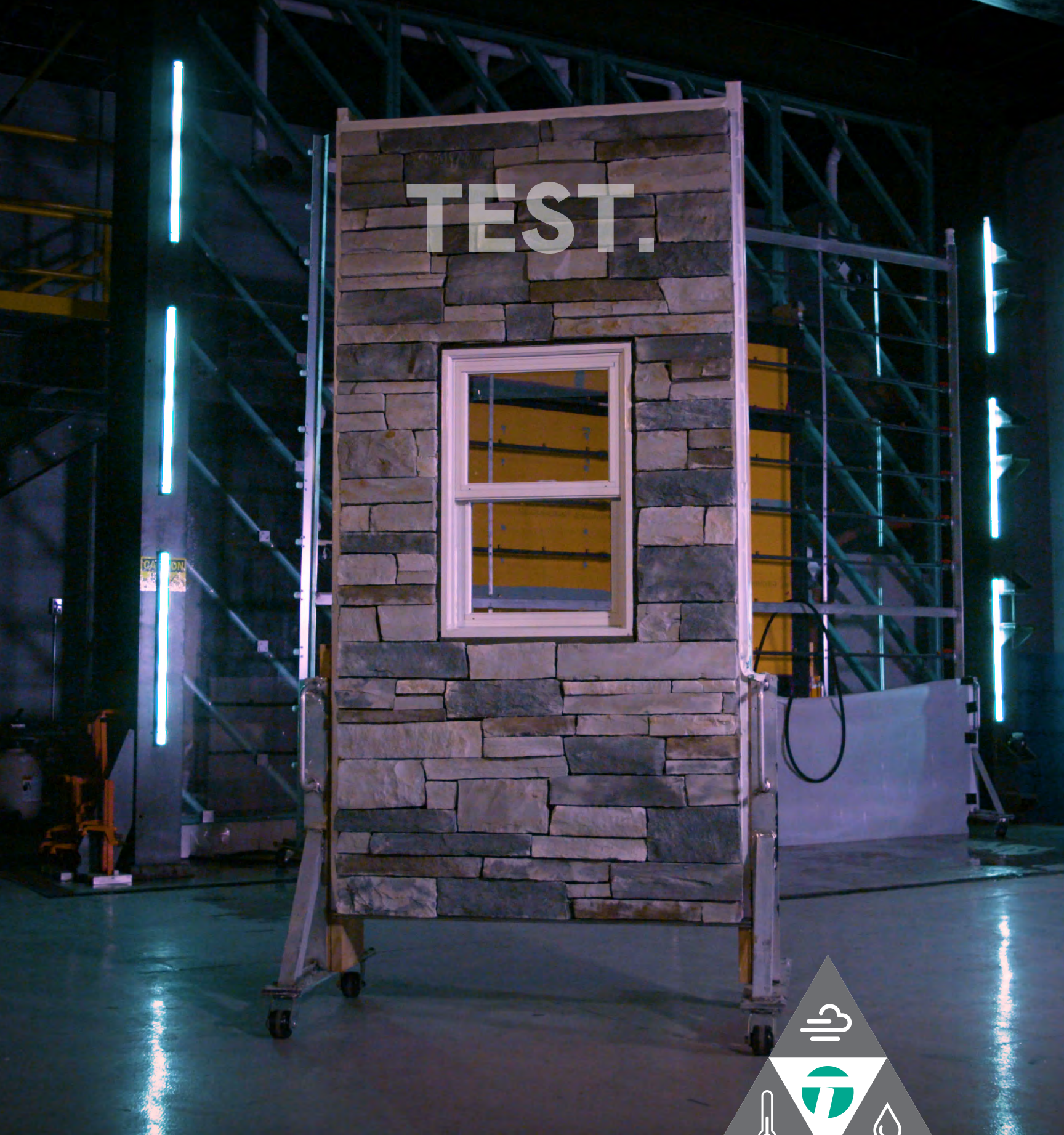

## BE CONFIDENT YOUR STRUCTURES AND SYSTEMS WILL PERFORM AS INTENDED

We're committed to helping architects design and construct leak-free and long-lasting buildings through comprehensive testing at our one-of-a-kind Building Science Laboratory.

Learn more about the Building Science Lab

Take a 360° Tour of the Facility

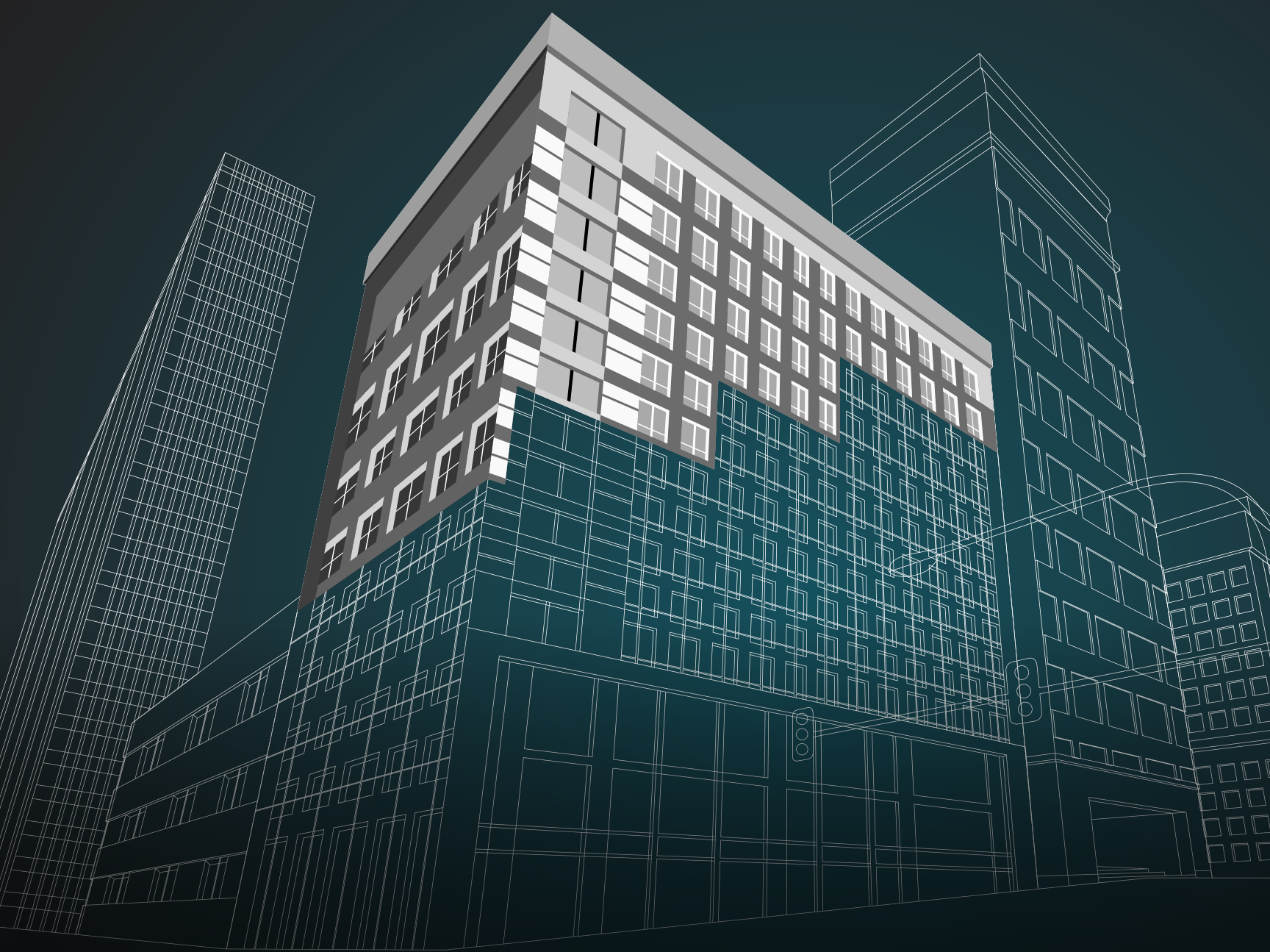

# SPECIFY.

## SPECIFY TREMCO CPG IN YOUR NEXT PROJECT

We've made it easy to specify Tremco CPG for your next project. Find us in SpecLink or MasterSpec, easily specify a Whole Wall System in one place, or go directly to each of our brands' specs.



Find us in SpecLink

Tremco Specifications



Find us in MasterSpec

Nudura Specifications

Specify a  
Whole Wall System

Dryvit Specifications

# SIMPLIFY.



## EASILY INCORPORATE A WHOLE WALL SYSTEM

A Tremco CPG whole wall system includes all building envelope components from the structural, through the barriers, joints and sealants, all the way out to the CI and exterior finish.

This unique approach helps ensure an air- and watertight building envelope, improved energy efficiency, and reduced construction time and labor costs caused by compatibility issues on the jobsite.

[Learn More About Whole Wall Systems](#)

[See More About Our Approach](#)

# CONSERVE.



## MEET ANY SUSTAINABILITY OR PERFORMANCE STANDARD

Tremco CPG systems help your projects meet or exceed the most stringent performance standards, such as LEED, GREENGUARD and Living Building Challenge (LBC). Our solutions aid buildings in attaining rigorous energy goals including net-zero, net-positive and Deep Energy Retrofits (DER) initiatives.

[Our Sustainability Initiatives](#)

[Deep Energy Retrofit Guide](#)





# SAMPLE.

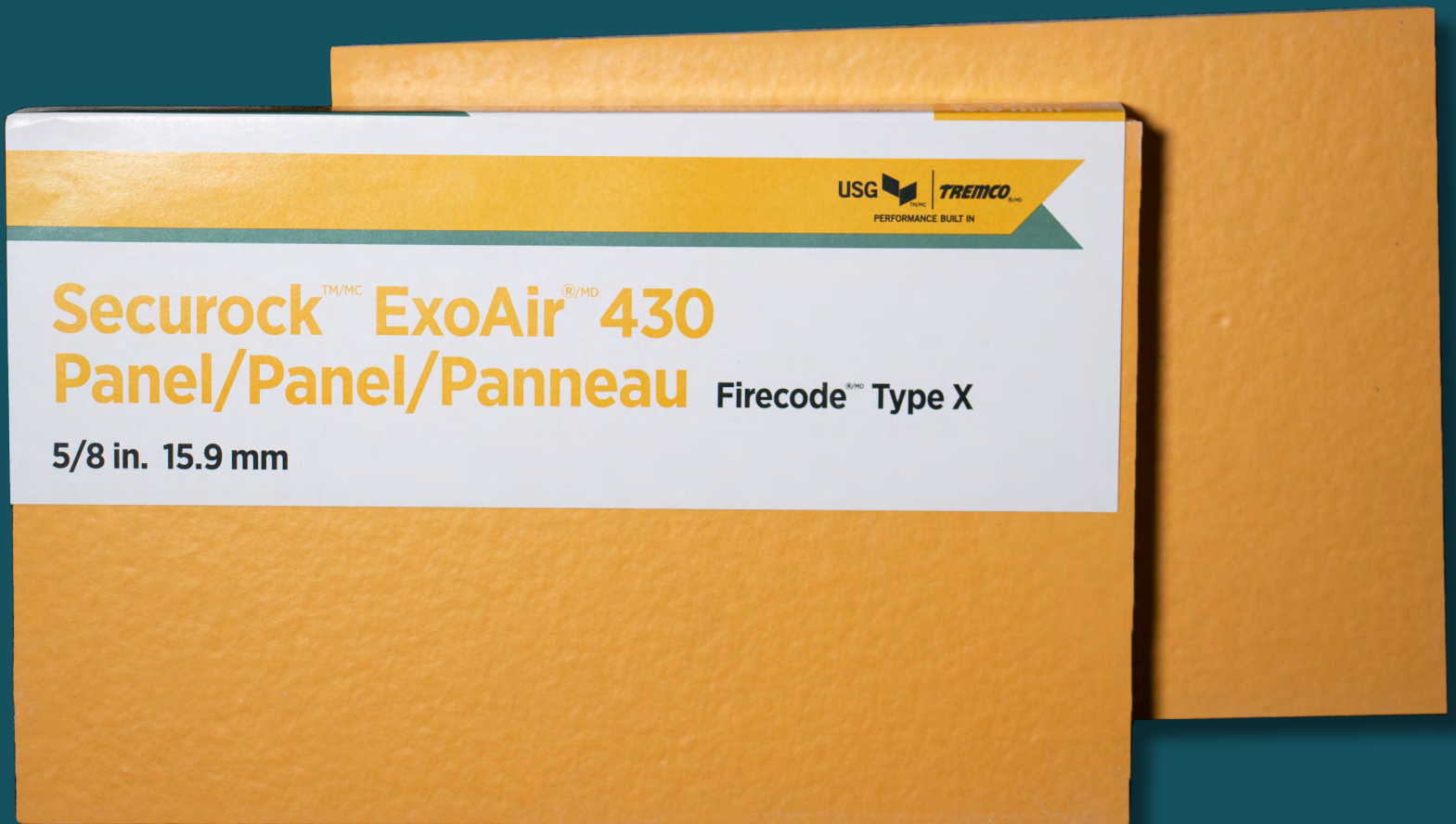

## EASILY ORDER PRODUCT SAMPLES & LITERATURE

Get product samples, literature and more delivered straight to your home or office. Log into the Tremco CPG Resource Center to see available items across all of our brands.

[Order Samples  
or Literature](#)

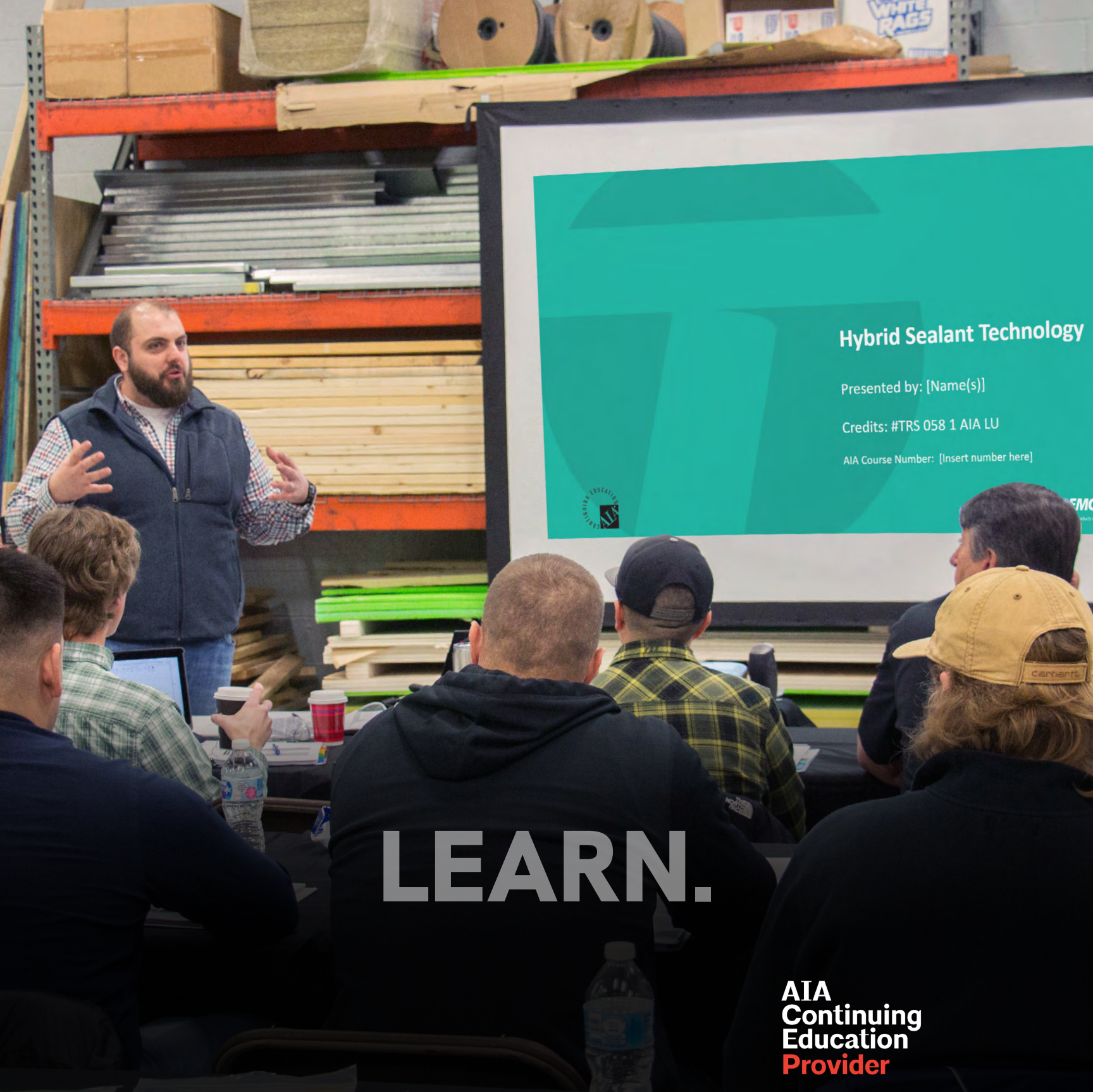

**Hybrid Sealant Technology**

Presented by: [Name(s)]

Credits: #TRS 058 1 AIA LU

AIA Course Number: [Insert number here]

**LEARN.**

**AIA**  
**Continuing**  
**Education**  
**Provider**

**FULFILL YOUR CE REQUIREMENTS IN ONE STOP**

View our free online webinars live or on-demand to earn AIA, IIBEC, or USGBC credits. We can even do in-office or private virtual sessions on a topic of your choice.

Subject areas cover everything from ICFs and waterproofing — to EIFS & finishes, roofing and more.

Explore Available  
 AIA-Accredited Courses

Enter our Continuing  
 Education Portal

Request an  
 In-Person Training



# OBSERVE.

“They were able to give us a comprehensive warranty — covering the entire building — from a single source. That was impossible from anybody else. A great selling point for the owners.”

**500 Pacific Ave.  
Bremerton, Washington**

Dryvit Air Barriers and Prefabricated Panels  
Tremco Traffic Coatings and Sealants

## SEE THE DIFFERENCE FOR YOURSELF

View a variety of educational videos, product overviews, project case studies, and architect testimonials here:

See More Videos on our  
YouTube Channel



Continuing Education  
for Design Professionals



A Whole Building Approach



Aspire Trade High School:  
Tremco CPG Whole Wall System

**tremcocpg.com**

0124.ARCBRO



Tremco Construction Products Group (CPG) brings together Tremco CPG Inc. and its Dryvit and Nudura brands; Willseal; Prebuck LLC; Tremco Barrier Solutions, Inc.; Weatherproofing Technologies, Inc. and its Pure Air Control Services and Canam Building Envelope Specialists offerings; and Weatherproofing Technologies Canada, Inc.